

S FLOOR PLAN

450 SQUARE FEET

STUDIO/1 BATH

4TH THROUGH 15TH FLOORS

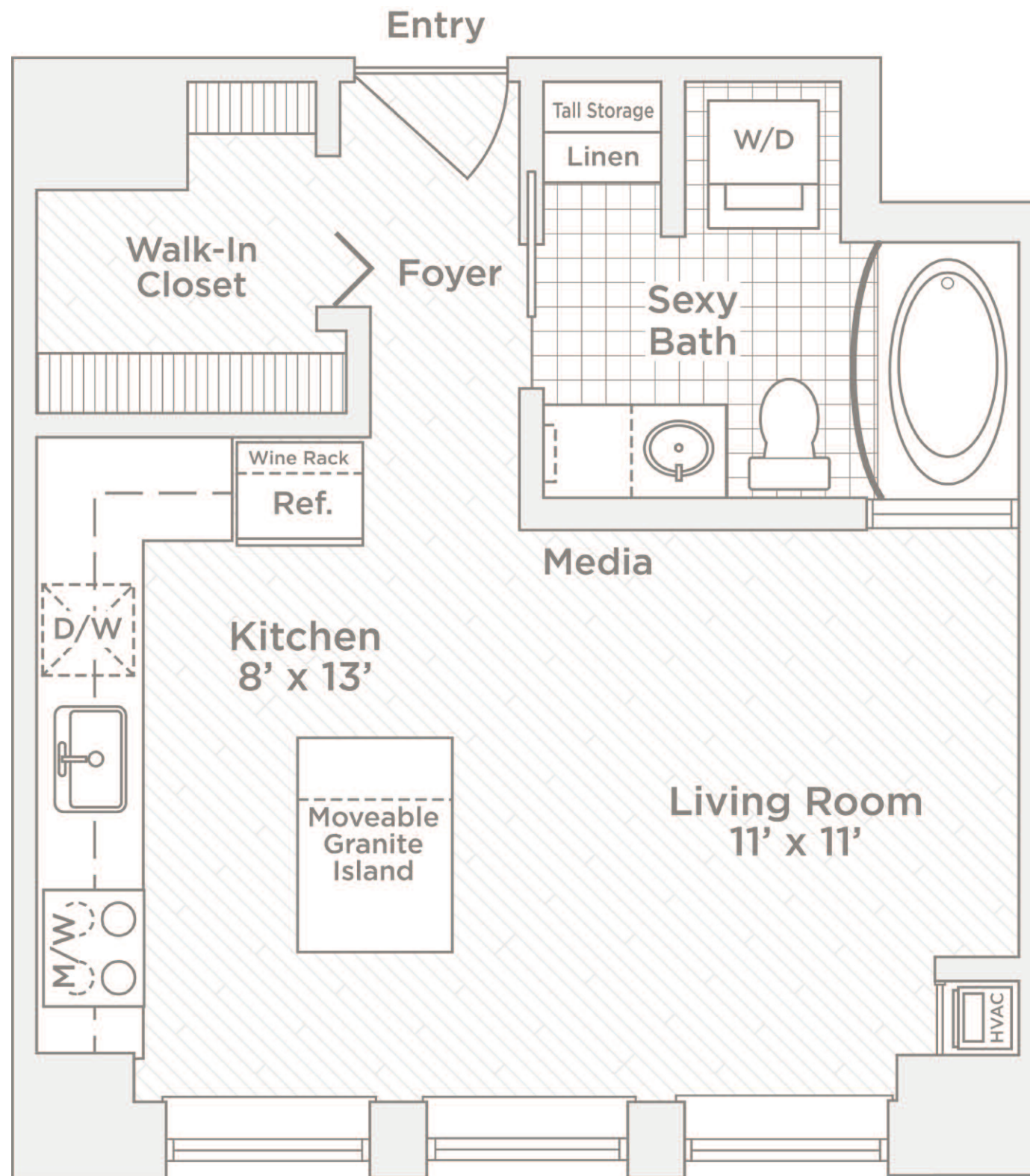

Unique studio floor plan includes the following world-class features and premium amenities:

Contemporary, white full-face kitchen cabinetry with brushed nickel hardware, white Whirlpool® appliances and above-range microwave

Custom kitchen finishes including stainless steel backsplash, glass accent doors and wine rack

Granite countertops and moveable desk height kitchen island with extra storage

Sexy bathroom with 36-inch soaking tub, subway tile surround, black and white hexagon tile floors, adjustable-height rain shower head, curved shower rod, cultured marble vanity, deep drawer storage, towel shelf, custom framed mirror and medicine cabinet.

Track lighting in kitchen and bath

Full-sized GE® stacked washer and dryer

Wood floors throughout living space

In-unit apartment storage and separate media nook

Natural light window in bathroom

Large custom walk-in closet with single and double-hung shelving, wall-mounted shoe rack and linen closet

Soaring 10-foot ceilings

Oversized windows with window treatments

Heating and cooling with a 24/7/365 programmable thermostat

Sound controlled and energy efficient environment

Engineered and built to achieve the NAHB Green Building Standard

Space-saving pocket and bi-fold doors

V.A.L.U. Added Luxury Upgrades available

Artist's rendition. Floorplans and finishes vary by apartment. All dimensions approximate.

5/13

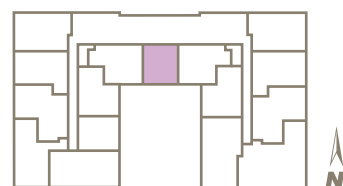

Floors: 4th-15th



SOO LINE BUILDING
CITY APARTMENTS

Your Name

Your Apartment

Your Address

Date

101 South 5th Street | Minneapolis, MN 55402

P: 612.808.6820 | F: 612.808.6821

soolinebldgcityapts.com



EXPLORE VILLAGEGREEN.COM